

SLR 21



Characteristics

SLR 21

- mounting frame with tank destined for plasterboard constructions, for mounting to the floor and to the back wall
- is destined for toilets and flushing units (mechanical, infra-red and electronic touch)
- five-point system for fixing of stainless steel toilets
- metal frame construction with surface finishing - blue powder coated
- adjustable height 1120 - 1290 mm
- adjustable depth 155 - 235 mm
- mounting screws M10, waste pipe holder with connecting set Ø 50 mm and waste pipe holder with the elbow pipe Ø 110 mm

Dimensions

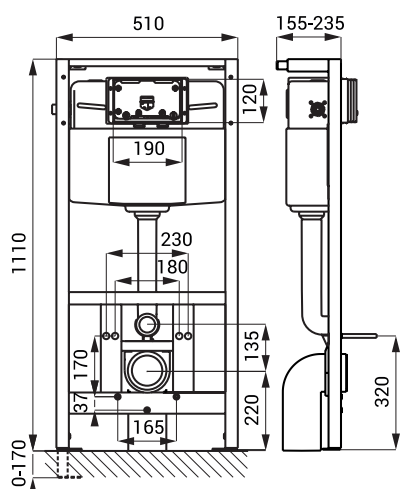

Supply Specification

SLR 21 - Supply No. 08210

mounting frame for plasterboard constructions, for mounting to the floor and to the back wall, for toilets and flushing units, mounting set, waste pipe holder with the elbow